

# INSTRUCTIONS FOR USE

**⚠ WARNING:** To minimise the risk of injury from improper and unsafe use of this cane, read these instructions and safety precautions before using.

## Intended Purpose:

This cane is a walking aid to assist those who have reduced mobility.

## Safety Precautions:

- Consult a healthcare professional before using any assisted mobility device.
- Not to be used by persons heavier than the maximum user mass (see Specifications).
- Not intended to support the full weight of the user.
- Not intended for use on ice or other slippery surfaces as it has the potential to slip.
- Do not use unless individual segments are joined together securely, and the push button is fully engaged.
- When assembling individual segments, keep fingers away to avoid being pinched.
- Do not stretch the internal elastic cord more than necessary to assemble or disassemble the segments. Do not use the cane if the elastic cord is cut, frayed, or damaged.
- Applying downward pressure on the tip (e.g. stepping on the tip) while lifting the handle can cause the cane segments to separate and the cane to collapse, possibly causing the user to fall.
- If the handle or tip becomes loose, or if the cane becomes damaged, stop using the cane immediately.

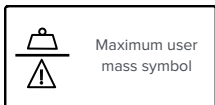

## SETUP

<p>1</p> <p>Remove zip ties before use</p>	<p>2</p> <p>Slide collar off the tubes</p>	<p>3</p> <p>Unfold</p>
<p>4</p> <p>Check that joints are secure</p> <p><b>IMPORTANT:</b> Ensure segments are joined securely, and the push button is fully engaged.</p>	<p>Adjustable collar available with some walking sticks</p> <p>5</p> <p>Adjust height</p> <p>Loosen (Clockwise)</p> <p>Push</p> <p>Adjust</p> <p>Tighten (Counterclockwise)</p>	

## SAFETY PRECAUTIONS

<p>1</p> <p>Keep fingers away and do NOT over-stretch</p>	<p>2</p> <p>Ensure the tip is secure</p>	<p>3</p> <p><b>⚠ WARNING:</b></p> <p>Lifting the handle while stepping on the tip may cause the walking stick to separate and collapse.</p>						
<p>4</p> <p><b>SURFACE TIPS</b></p> <p>These folding walking sticks are not designed for use on all surfaces. Take particular care on these surfaces:</p> <table border="0"><tr><td data-bbox="122 2020 218 2100"></td><td data-bbox="308 2020 393 2100"></td><td data-bbox="484 2020 569 2100"></td></tr><tr><td data-bbox="106 2112 212 2135">Uneven ground</td><td data-bbox="287 2112 404 2135">Very soft ground</td><td data-bbox="473 2112 569 2135">Wet surfaces</td></tr></table>						Uneven ground	Very soft ground	Wet surfaces
Uneven ground	Very soft ground	Wet surfaces						

# MAINTENANCE

- Check the elastic cord before every use. Do not use the cane if the cord is cut, frayed, or damaged.
- Check the handle and tip are secure.
- Periodically check the wrist strap to ensure that it is secure.
- Replace the tip every six months. Contact Drive DeVilbiss Healthcare Ltd using the tip codes below, or contact your local distributor to purchase new tips.
- Clean the cane occasionally using water and a mild detergent.
- For Glow and Go walking sticks, charge for 45 minutes in ambient light.

## FEATURES

- Aluminium cane material
- Five adjustable heights in 2.5 cm (1") increments
- Folds into 4 parts for easy storage
- Hard-wearing, non-slip tips
- Easy to wipe clean

## Comments, Feedback, or Questions

For assistance with using your folding cane or for any warranty, sales or customer service information, please contact your distributor or retailer. If in doubt, contact Drive DeVilbiss Healthcare Ltd.

If a serious incident occurs in relation to the product, reports should be forwarded to the manufacturer and local competent authority.

# SPECIFICATIONS

	Size	Weight	Max User Mass	Handle Type	Colours	Product Code	Tip Code
Walking Stick with Soft Grip Handle	82.5 - 92.5 cm (32.5-36.5")	380g	135kg (21st)	Soft Grip	Black	10370BLK-6	
					Blue Crackle	10370BC-6	
					Red Crackle	10370RC-6	
Small Walking Stick with Soft Grip Handle	72.5 - 82.5 cm (28.5-32.5")	365g	135kg (21st)	Soft Grip	Polka Dot	WS024PD	
					Stripe	WS024ST	
Walking Stick with Wooden Handle	84-94cm (33-37")	360g	135kg (21st)	Wooden	Black Twist	10304BKT-6S	RTL10322BKB
					Black Wave	10304BKW-6S	
					Black Paisley	10304PB-6S	
					Blue Crackle	10304BC-6S	
					Blue Ice	10304BI-6S	
					Blue Twist	10304BT-6S	
					Spiral Blue Wave	10304SBW-6S	
					Blossom Red	10304BR-6S	
					Red Crackle	10304RC-6S	
					Spiral Red Wave	10304SRW-6S	
					Stained Glass	10304SG-6S	
Amoeba Green	10304CAG-6S						
Glow and Go Walking Stick with Gel Handle	84-94cm (33-37")	400g	135kg (21st)	Gel	Copper	RTL10304CR	FER19SCR
					Tye Dye	RTL10304TD	FER19STD

# STORAGE INSTRUCTIONS

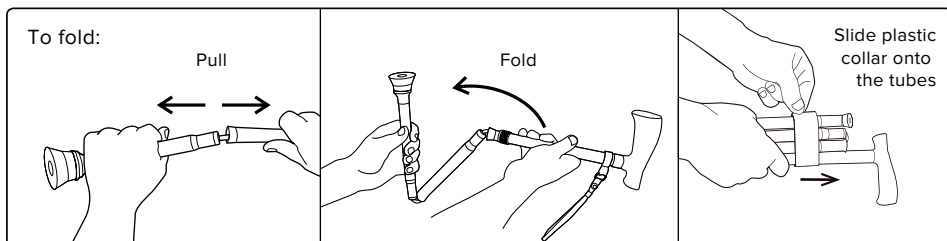

When the product has come to the end of its useful life, follow local recycling and disposal policies.



Com-Da Healthcare Co. Ltd.  
No. 1, Jinzhao Street, West District,  
Zhongshan City, Guangdong, CN



Drive DeVilbiss Healthcare Ltd.  
Sidhill Business Park,  
Holmfield, Halifax,  
West Yorkshire, HX2 9TN, Great Britain

+44 (0) 845 0600 333

info@drivedevilbiss.co.uk www.drivedevilbiss.co.uk



Osmunda Medical Technology Service GmbH  
Treskowallee 108, 10318 Berlin, DE

Drive DeVilbiss Sidhill Ltd.  
4 Trench Road, Mallusk, Newtownabbey  
BT36 4TY, Northern Ireland

